

TECH DATA SHEET

Frontier Multi Test Toe Sleeve

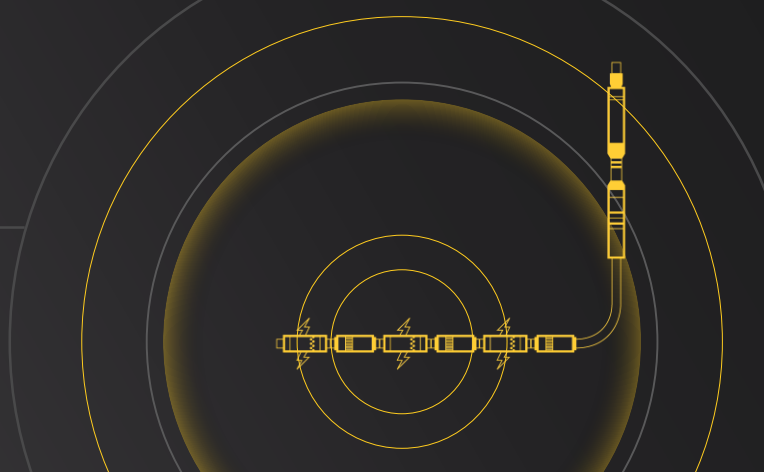

OVERVIEW

The Multi Test Toe Valve eliminates the need for Tubing Conveyed Perforating (TCP) Toe Prep by providing a simple and reliable hydraulically actuated injection path. The Multi Test Toe Valve allows the Toe Valve to be opened without exceeding the desired test pressure and unlimited hold period. The Multi Test Toe Valve can also be pressure tested multiple times below the activation pressure.

FEATURES

- Multiple Pressure Tests can be Applied Prior to Opening
- Can be Functioned Without Exceeding Test Pressure
- Unlimited Time Pressure Hold on Final Cycle
- Each Valve Toe Valve Configured to Suit Well Application
- Adjustable Activation Pressure
- Rupture Disc's with +/- 2% Accuracy
- Multiple Toe Valves can be Run in Series
- Large Flow Area Injection Ports Reduces the Risk Of Plug in the First Stage
- Opening Pressure Not Affected By Well Bore Pressure
- Optional Ball Seat, which allows for DFIT to be Performed
- Absolute Pressure Rating 18,000psi

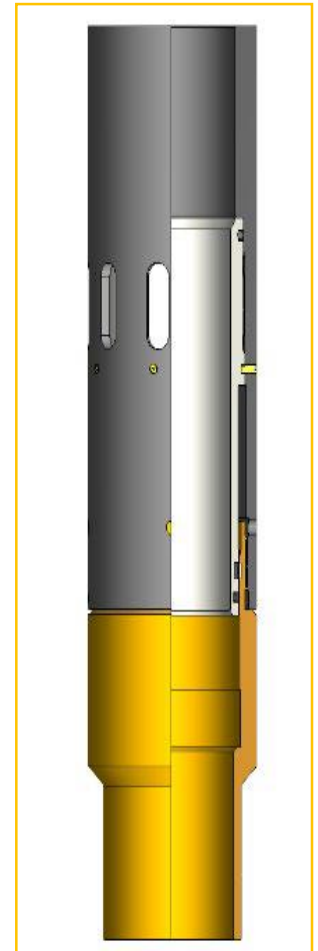

APPLICATIONS

- Multistage Frac Completions
- Toe Initiation

Specifications and Dimensions

| Sleeve Size (In) | OD (In) | ID (In) | Length (In) | Flow Port Area (In ²) | Torque (ft-lbs) | Threads | Tensile (ft-lbs) |
|------------------|---------|---------|-------------|-----------------------------------|-----------------|---------|------------------|
| 4.500 | 5.875 | 3.28 | 57.625 | 11.2 | 25,000 | ** | 325,000 |
| 5.000 | 5.875 | 3.28 | 57.625 | 11.2 | 25,000 | ** | 325,000 |
| 5.500 | 6.875 | 4.00 | 57.650 | 14.3 | 40,000 | ** | 535,000 |

** Connections as Required

